



FabLink[®]-MD25.4.FG

Bakery Applications

Oven Infeed - Outfeed, Cooling Lines, Coating Lines, Glazing Lines, Freezing Lines, Conditioning Lines

Poultry Applications

Skinning, Breeding Machines and Grading Lines

Seafood Applications

Breeding Machines, Draining Lines, Glazing Lines, Elevators, Freezing Lines

Snack Food Applications

Proofer Lines, Boiler Infeed, Oven Infeed - Outfeed, Cooling Lines

Fruits and Vegetables Applications

Prewashing - Rinsing, Draining, Blanching Lines, Elevators

Packaging Applications

Filling, Accumulation Palletizing - Depalletizing, Box Transfer

Textile Applications

Cutter, Dyeing

FabLink®-MD25.4.FG

Pitch	25.4 mm / 1 inch
Belt surface	Close, Smooth Surface
Minimum width	50 mm / 1.97 inch
Open Area (%)	33% (Biggest opening 5.5 x 7 mm)
Cleat	Yes (T25, T50, TC50, TCH50, TNC75, TNC100, T75, T100)
Sidewall	Yes (h=25mm, h=50mm, h=75mm, h=100mm)
Pin	Ø 5 mm / 0,197 inch Self Lock
Approved	FDA and EU
Curve	No
Color	Additional colors available
Cleanability	Good
Belt thickness	10 mm / 0,394 inch



Product Features and Functional Benefits

- Belt provides optimal open area for drainage and airflow.
- Less friction and product contact for easy cooking, cooling and freezing of products.
- Reduced dirt and oxide build due to self cleaning surface.
- Bi-directional belt for long conveyors.
- Stainless steel pins option for high temperature applications.

Available Moulded Module Sizes

- 200 mm / 7.87 inch module
- 100 mm / 3.94 inch module
- 50 mm / 1.97 inch module
- 33 mm / 1.30 inch module

Technical Information

BELT MATERIAL	BELT STRENGTH				TEMPERATURE		BELT WEIGHT Kg/m ² / lb/ft ²
	Straight		Curve		°C / ° F (min.)	°C / ° F (max.)	
	N/mm	lb/ft	N/mm	lb/ft			
PP (Polypropylene)	15400	1055	-	-	+5 / +41	+90 / +194	4,6 / 0.94
PE (Polyethylene)	8800	603	-	-	-73 / -99	+66 / +150.8	5,1 / 1.04
POM (Polyacetal)	27170	1861	-	-	-43 / -45	+110 / +230	7,1 / 1.45

Standard Belt Widths

WIDTH (W)				BELT WIDTH TOLERANCE (max.)
PP-PE		POM		
mm	inch	mm	inch	
200,0	7.87	200,0	7.87	± 1 mm
250,0	9.84	250,0	9.84	± 1 mm
300,0	11.81	300,0	11.81	± 2 mm
350,0	13.77	350,0	13.77	± 2 mm
400,0	15.75	400,0	15.75	± 2 mm
450,0	17.71	450,0	17.71	± 2 mm
500,0	19.69	500,0	19.69	± 2 mm
550,0	21.65	550,0	21.65	± 3 mm
600,0	23.62	600,0	23.62	± 3 mm
650,0	25.60	650,0	25.60	± 3 mm
700,0	27.56	700,0	27.56	± 3 mm
750,0	29.50	750,0	29.50	± 3 mm
800,0	31.50	800,0	31.50	± 3 mm
850,0	33.46	850,0	33.46	± 4 mm
900,0	35.43	900,0	35.43	± 4 mm

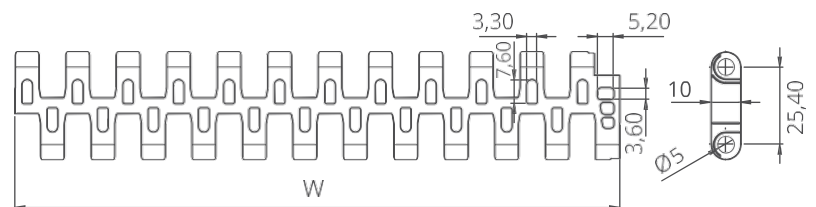

- Standard belt increments 50mm
 - Non-standard belt increments 16.6 mm
- Please contact with customer service for precise belt measurements

Sprockets and Technical Specifications

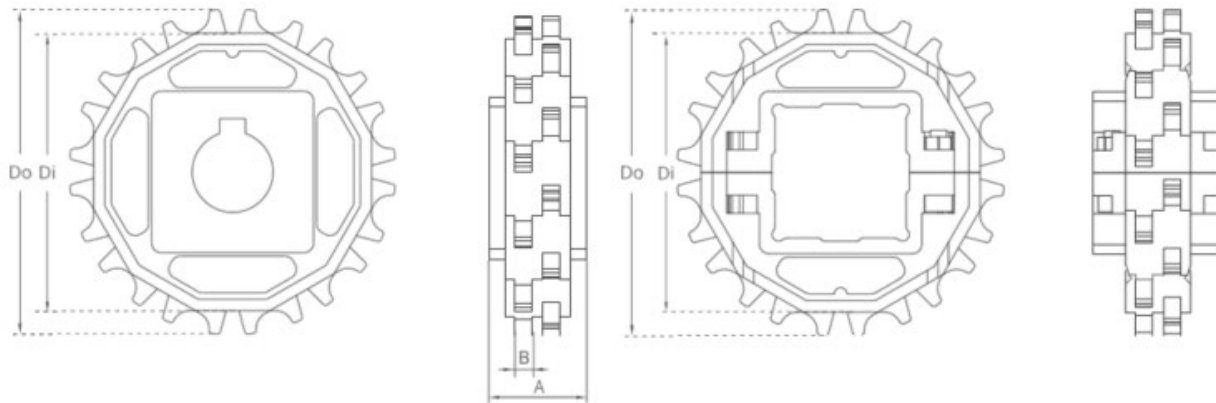

Standard Sprocket Dimensions

NUMBER OF TEETH	Di mm / inch	Do mm / inch	B mm / inch	A mm / inch	Square Bore (Q) mm / inch	Round Bore (R) mm / inch	PRODUCT CODE	
							Square Type (Q)	Round Type (R)
Z8	52,0 / 2.05	67,0 / 2.64	6 / 0.24	30 / 1.18	25 / 1	25 / 1	FL-MD-TR-254SQ25Z8	FL-MD-TR-254SRZ8
Z10	69,0 / 2.72	84,0 / 3.31	6 / 0.24	30 / 1.18	40 / 1.5	25-30 / 1-1.25	FL-MD-TR-254SQZ10	FL-MD-TR-254SRZ10
Z12	85,8 / 3.38	100,8 / 3.97	6 / 0.24	30 / 1.18	40 / 1.5	25-30 / 1-1.25	FL-MD-TR-254SQZ12	FL-MD-TR-254SRZ12
Z15	110,8 / 4.36	125,8 / 4.95	6 / 0.24	30 / 1.18	40 / 1.5	25-30 / 1-1.25	FL-MD-TR-254SQZ15	FL-MD-TR-254SRZ15
Z16	119,1 / 4.69	134,1 / 5.28	6 / 0.24	30 / 1.18	40 / 1.5	25-30 / 1-1.25	FL-MD-TR-254SQZ16	FL-MD-TR-254SRZ16
Z18	135,6 / 5.34	150,6 / 5.93	6 / 0.24	30 / 1.18	40 / 1.5	25-30 / 1-1.25	FL-MD-TR-254SQZ18	FL-MD-TR-254SRZ18
Z20	150,7 / 5.93	167,3 / 6.59	6 / 0.24	30 / 1.18	40 / 1.5	25-30 / 1-1.25	FL-MD-TR-254SQZ20	FL-MD-TR-254SRZ20

- * Other sprockets and hub sizes are manufactured upon request
- * PA (Polyamide) and PP (Polypropylene) sprockets are available upon request
- * Machined split sprockets are available for each size

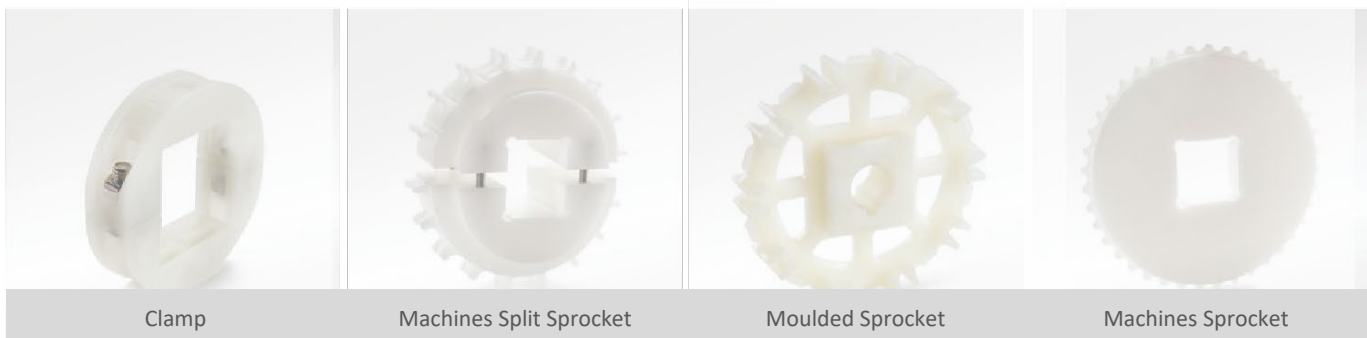

Clamp

Machines Split Sprocket

Moulded Sprocket

Machines Sprocket



CLEAT AND SIDEWALLS

Product code	Cleat Height (mm / inch)	Cleat Width (mm / inch)	Product code	Sidewall Height (mm / inch)
FL-MD-254T25	25 / 1	200 / 7.87	FL-MD-254SW25	25 / 1
FL-MD-254T50	50 / 2	200 / 7.87	FL-MD-254SW50	50 / 2
FL-MD-254T75	75 / 3	200 / 7.87	FL-MD-254SW75	75 / 3
FL-MD-254T100	100 / 4	200 / 7.87	FL-MD-254SW100	100 / 4
FL-MD-254TC50	50 / 2	200 / 7.87	-	-
FL-MD-254TCH50	50 / 2	200 / 7.87	-	-
FL-MD-254TNC75	75 / 3	200 / 7.87	-	-
FL-MD-254TNC100	100 / 4	200 / 7.87	-	-

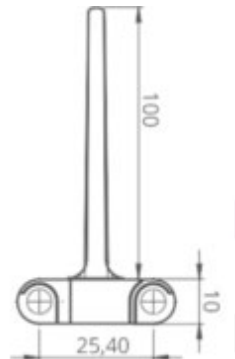
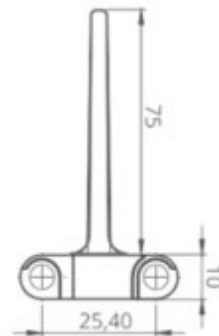
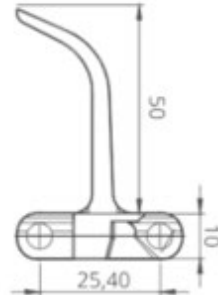
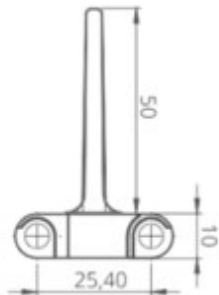
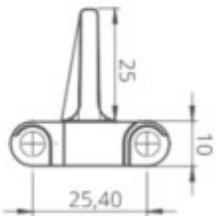

* Additional flight dimensions are available up to 100 mm.

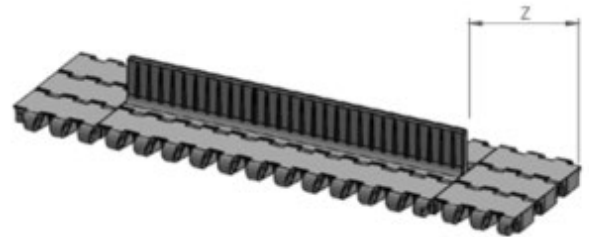
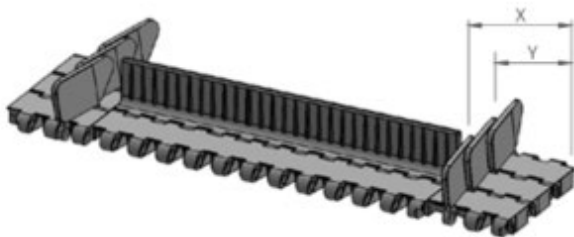

POSSIBLE SIDEWALL FREE ZONE	X		Y		POSSIBLE CLEAT FREE ZONE	Z	
	mm	inch	mm	inch		mm	inch
Standard, no module cutting	33,5	1.32	14,9	0.59	Standard, no module cutting	33,5	1.32
Non-Standard	41,9	1.65	23,3	0.92	Standard, no module cutting	50,0	1.97
Standard, no module cutting	50,0	1.97	31,6	1.24	Standard, module cutting	83,5	3.29
Non-Standard	58,6	2.31	39,9	1.57	Standard, no module cutting	100,0	3.94
Standard, module cutting necessary	66,9	2.63	48,5	1.91	Standard, no module cutting	33,5	1.32
Non-Standard	75,2	2.96	56,8	2.24	Standard, no module cutting	50,0	1.97

Note: Gap between cleat and sidewall minimum 2-3 mm

Non-standard cleat is upon request

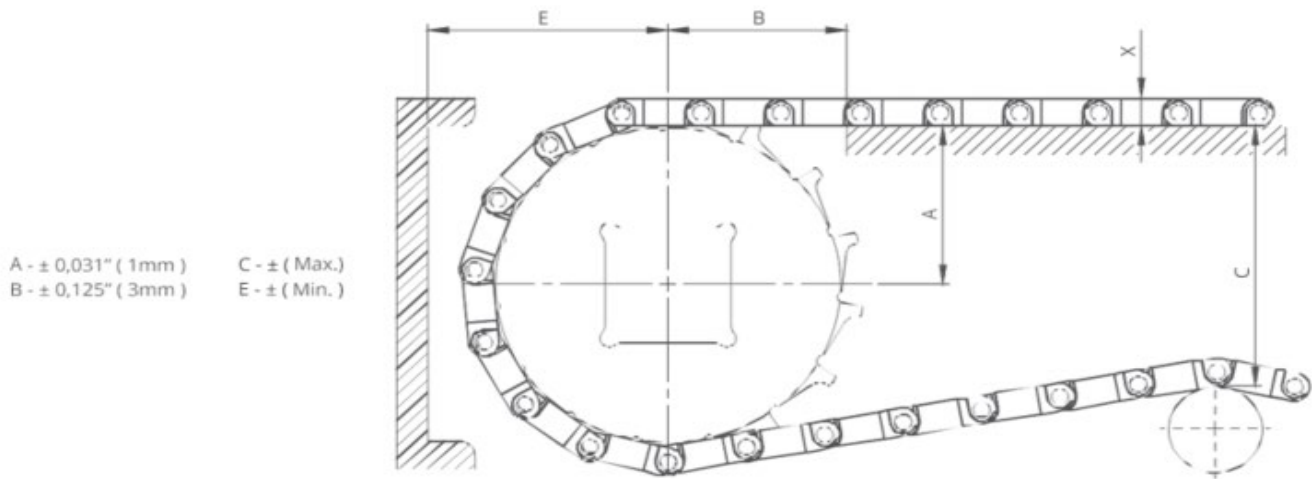

Conveyor Frame Dimensions

SPROCKETS DESCRIPTION		A		B		C		E		X		
Pitch Diameter	Number of teeth	Range (Bottom to Top)		inch	mm	inch	mm	inch	mm	inch	mm	
		inch	mm									
FabLink®MD25.4.FG, FabLink®MD25.4.C												
2.38	60,5	8	1.15	29,2	1.55	39,4	1.95	49,5	1.94	49,2	0.39	10,0
3.07	78,0	10	1.46	37,1	1.77	45,0	2.60	66,1	2.25	57,1	0.39	10,0
3.74	95,0	12	1.76	44,8	1.97	50,1	3.24	82,3	2.55	64,8	0.39	10,0
4.70	119,5	15	2.22	56,4	2.23	56,7	4.18	106,1	3.01	76,4	0.39	10,0
5.02	127,5	16	2.37	60,2	2.38	60,5	4.46	113,2	3.21	81,5	0.39	10,0
5.71	145,0	18	2.73	69,3	2.45	62,3	5.19	131,8	3.51	89,3	0.39	10,0
FabLink®MD25.4.RR, FabLink®MD25.4.GT												
2.38	60,5	8	1.15	29,2	1.55	39,4	1.95	49,5	2.18	55,4	0.64	16,3
3.07	78,0	10	1.46	37,1	1.77	45,0	2.60	66,1	2.48	63,1	0.64	16,3
3.74	95,0	12	1.76	44,8	1.97	50,1	3.24	82,3	2.79	70,9	0.64	16,3
4.70	119,5	15	2.22	56,4	2.23	56,7	4.18	106,1	3.25	82,7	0.64	16,3
5.02	127,5	16	2.37	60,2	2.38	60,5	4.46	113,2	3.46	87,8	0.64	16,3
5.71	145,0	18	2.73	69,3	2.45	62,3	5.19	131,8	3.76	95,5	0.64	16,3

Slider Support System for Straight Running Belts

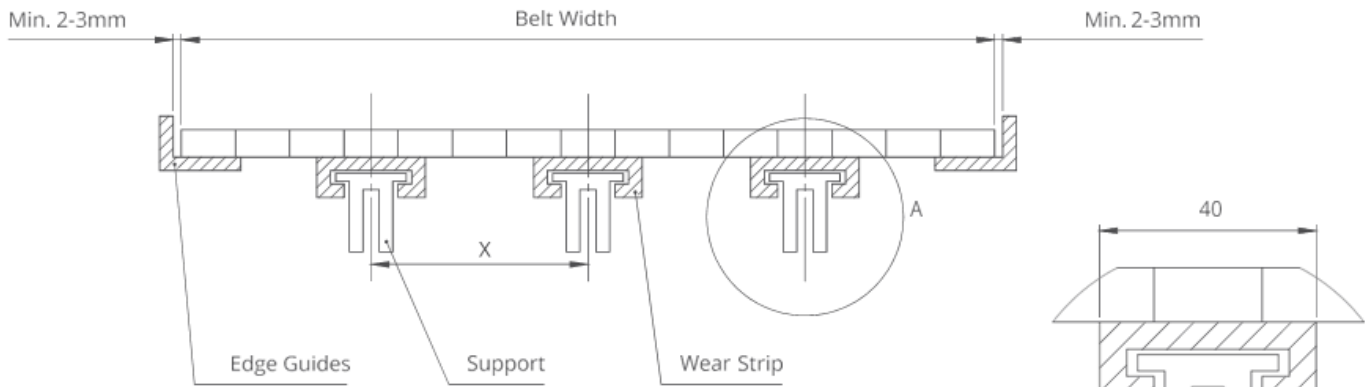

Note: The max. distances between the wear strips have to be (X) ;

125 mm for 2" belts
80 mm for 1" / 0.5" belts

Detail A
Scale 1:1

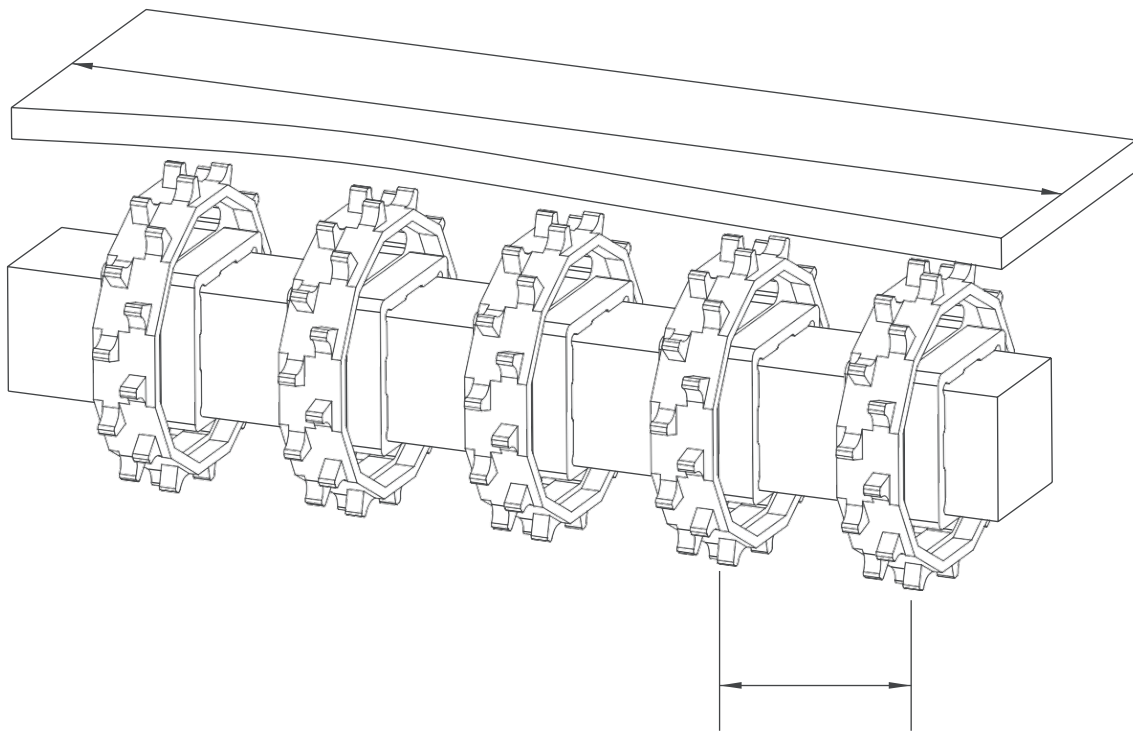

Sprockets Arrangement

Standard Belt Width		Number of sprockets per shaft		A (mm/inch)	
mm	inch	Drive Shaft	Return Shaft	Min.	Max.
150,0	6.0	2	2	50 / 2	120 / 4.7
200,0	8.0	2	2	50 / 2	120 / 4.7
250,0	10.0	3	2	50 / 2	120 / 4.7
300,0	12.0	3	2	50 / 2	120 / 4.7
350,0	14.0	3	3	50 / 2	120 / 4.7
400,0	16.0	4	3	50 / 2	120 / 4.7
450,0	18.0	4	3	50 / 2	120 / 4.7
500,0	20.0	5	4	50 / 2	120 / 4.7
550,0	22.0	5	4	50 / 2	120 / 4.7
600,0	24.0	6	5	50 / 2	120 / 4.7
700,0	26.0	7	5	50 / 2	120 / 4.7
800,0	28.0	8	6	50 / 2	120 / 4.7
900,0	30.0	9	7	50 / 2	120 / 4.7
1000,0	32.0	10	7	50 / 2	120 / 4.7

Note: number of sprockets depends on belt load