



FabLink®-EC25.4.NT

Meat (Beef and Pork) Applications

Elevator

Poultry Applications

Elevator, Freezing Lines

Seafood Applications

Control Tables, Glazing

Fruits and Vegetables

Including Elevator

FabLink® EC25.4.NT

Pitch	25.4 mm / 1 inch
Belt surface	Close, Nub Top surface
Minimum width	152.4 mm / 6 inch
Open Area (%)	0%
Cleat	Yes (T25, T50, T75, TC75, TCH75, T100, TNC50, TNC100)
Sidewall	Yes (h=25 mm, h=50 mm, h=75 mm, h=100 mm)
Pin	Ø 5 mm / 0,197 inch – Self lock
Approved	FDA and EU
Curve	No
Color	Additional colors available
Cleanability	Excellent
Belt thickness	12.5 mm / 0.472 inch



Product Features and Functional Benefits

- Easy to clean reduces downtime for cleaning time 70%.
- Reduces bacteria growth.
- Non-adhesive due to reduced contact surface.
- Close transfer applications.
- Easy to clean reduces downtime for cleaning time 70%.

Available Moulded Module Sizes

- 152.4 mm / 6 inch module
- 152.4 mm / 6 inch edge module with 45 mm indent

Technical Information

BELT MATERIAL	BELT STRENGTH				TEMPERATURE		BELT WEIGHT Kg/m ² / lb/ft ²
	Straight		Curve		°C / ° F (min.)	°C / ° F (max.)	
	N/mm	lb/ft	N/mm	lb/ft			
PP (Polypropylene)	15400	1055	-	-	+5 / +41	+90 / +194	5,1 / 1.05
PE (Polyethylene)	8800	603	-	-	-73 / -99	+66 / +150.8	5,4 / 1.11
Acetal	25150	1723	-	-	-43 / -45	+110 / +230	7,7 / 1.57

Standard Belt Widths

WIDTH (W)				BELT WIDTH TOLERANCE (max.)
PP-PE		POM		
mm	inch	mm	inch	
152,4	6.0	152,4	6.0	± 0,5 mm
228,6	9.0	228,6	9.0	± 2 mm
304,8	12.0	304,8	12.0	± 2 mm
381,0	15.0	381,0	15.0	± 3 mm
457,2	18.0	457,2	18.0	± 3 mm
533,4	21.0	533,4	21.0	± 3 mm
609,6	24.0	609,6	24.0	± 3 mm
685,8	27.0	685,8	27.0	± 4 mm
762,0	30.0	762,0	30.0	± 4 mm
838,2	33.0	838,2	33.0	± 4 mm
914,4	36.0	914,4	36.0	± 4 mm
990,6	39.0	990,6	39.0	± 4 mm
1066,8	42.0	1066,8	42.0	± 4 mm
1143,0	45.0	1143,0	45.0	± 4 mm

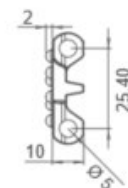
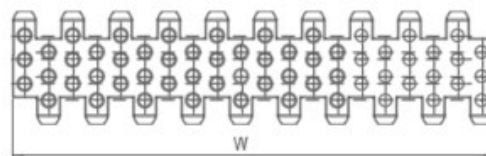

- Standard belt increments 76.2mm
 - Non-standard belt increments 15.2mm
- Please contact with customer service for precise belt measurements

Sprockets and Technical Specifications

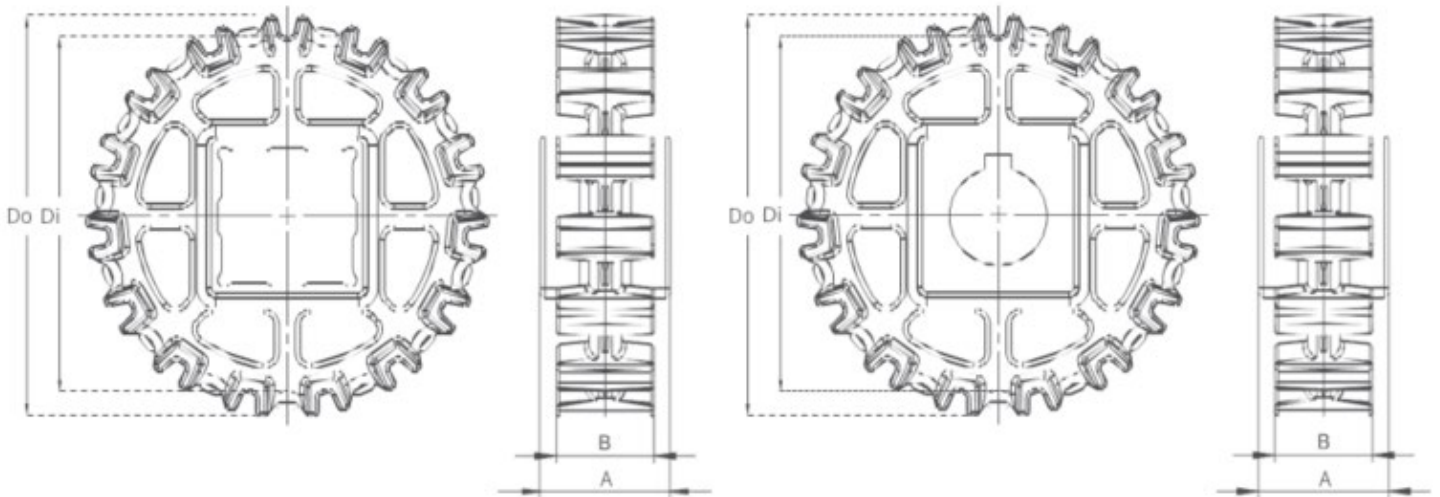

Standard Sprocket Dimensions

NUMBER OF TEETH	Di mm / inch	Do mm / inch	B mm / inch	A mm / inch	Square Bore (Q) mm / inch	Round Bore (R) mm / inch	PRODUCT CODE	
							Square Type (Q)	Round Type (R)
Z8	51,6 / 2.03	64,6 / 2.54	30 / 1.18	40 / 1.57	25 / 1	25 / 1	FL-EC-254SQZ8	FL-EC-254SRZ8
Z10	68,8 / 2.71	81,8 / 3.22	30 / 1.18	40 / 1.57	40 / 1.5	25-30 / 1-1.25	FL-EC-254SQZ10	FL-EC-254SRZ10
Z12	85,5 / 3.37	98,8 / 3.89	30 / 1.18	40 / 1.57	40 / 1.5	25-30 / 1-1.25	FL-EC-254SQZ12	FL-EC-254SRZ12
Z15	111,1 / 4.37	124,1 / 4.89	30 / 1.18	40 / 1.57	40 / 1.5	25-30 / 1-1.25	FL-EC-254SQZ15	FL-EC-254SRZ15
Z18	136,1 / 5.36	149,1 / 5.87	30 / 1.18	40 / 1.57	40 / 1.5	25-30 / 1-1.25	FL-EC-254SQZ18	FL-EC-254SRZ18

- * Other sprockets and hub sizes are manufactured upon request
- * PA (Polyamide) and PP (Polypropylene) sprockets are available upon request
- * Machined split sprockets are available for each size

*Machined Split Sprockets are available for each size

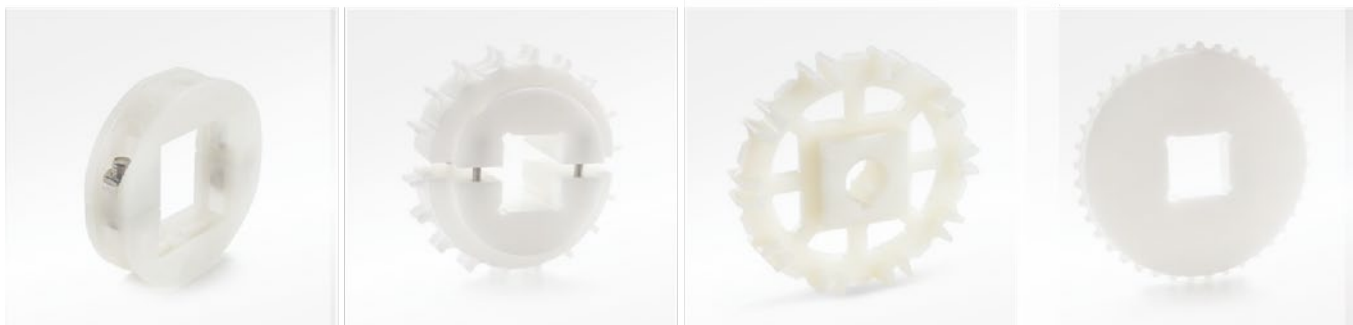

Clamp

Machined Split Sprocket

Moulded Sprocket

Machined Sprocket

Accessories and Technical Specifications



Cleats and sidewalls

Product code	Cleat Height (mm / inch)	Cleat Width (mm / inch)	Product code	Sidewall Height (mm / inch)
FL-EC-254T25	25 / 1	152,4 / 6	FL-EC-254SW25	25 / 1
FL-EC-254T50	50 / 2	152,4 / 6	FL-EC-254SW50	50 / 2
FL-EC-254T75	75 / 3	152,4 / 6	FL-EC-254SW75	75 / 3
FL-EC-254T100	100 / 4	152,4 / 6	FL-EC-254SW100	100 / 4
FL-EC-254TC75	75 / 3	152,4 / 6	-	-
FL-EC-254TCH75	75 / 3	152,4 / 6	-	-
FL-EC-254TNC50	50 / 2	152,4 / 6	-	-
FL-EC-254TNC100	100 / 4	152,4 / 6	-	-

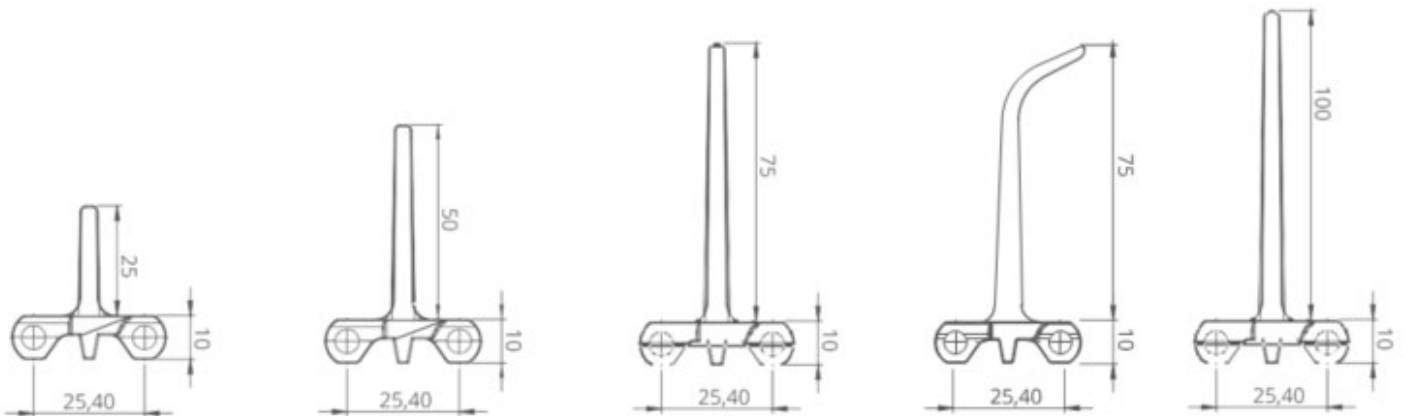

* Additional flight dimensions are available up to 100 mm.

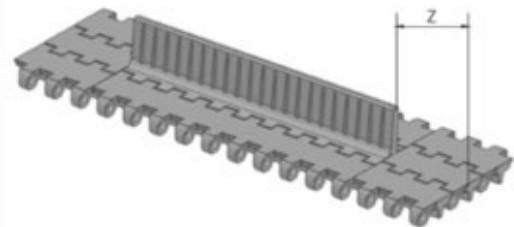
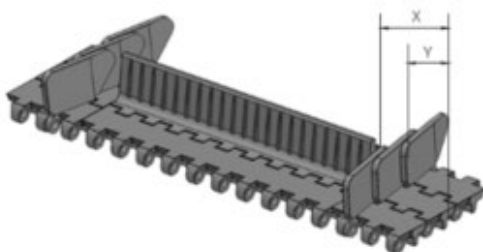

POSSIBLE SIDEWALL FREE ZONE	X		Y	
	mm	inch	mm	inch
Standard, no module cutting	24,0	0,94	15,0	0,59
Module cutting necessary	32,0	1,26	22,0	0,87
Standard, no module cutting	40,0	1,57	30,0	1,18
Module cutting necessary	48,0	1,89	37,0	1,46
Standard, no module cutting	56,0	2,20	45,0	1,77
Module cutting necessary	64,0	2,52	53,0	2,09

POSSIBLE CLEAT FREE ZONE	Z	
	mm	inch
Standard, module cutting	15,0	0,59
Standard, no module cutting	30,0	1,18
Standard, module cutting	45,0	1,77
Standard, module cutting	60,0	2,36
Standard, no module cutting	76,0	2,99

Note: Gap between Cleat and sidewall minimum 2-3 mm maximum 10 mm

Non-standard cleat is upon request

Engineering Information

A - $\pm 0,031"$ (1mm) C - \pm (Max.)
 B - $\pm 0,125"$ (3mm) E - \pm (Min.)

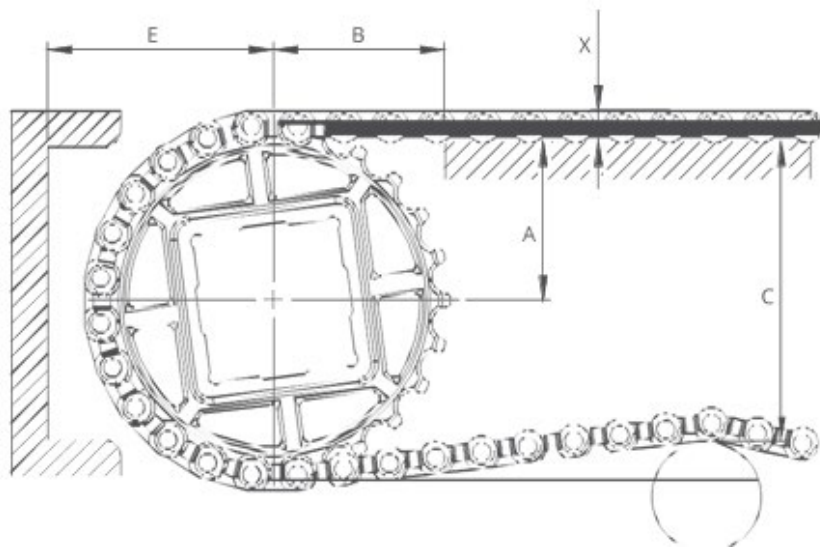

Conveyor Frame Dimensions

SPROCKETS DESCRIPTION			A		B		C		E		X	
Pitch Diameter		Number of teeth	Range (Bottom to Top)		inch	mm	inch	mm	inch	mm	inch	mm
inch	mm		inch	mm								
2.30	58,5	8	1.16	29,4	1.48	37,6	1.92	48,7	1.94	49,4	0.39	10,0
2.97	75,5	10	1.48	37,5	1.69	42,9	2.57	65,3	2.26	57,5	0.39	10,0
3.63	92,3	12	1.80	45,8	1.87	47,4	3.23	82,0	2.59	65,8	0.39	10,0
4.65	118,0	15	2.23	56,7	2.16	54,9	4.16	105,7	3.02	76,7	0.39	10,0
5.63	143,0	18	2.75	70,0	2.35	59,7	5.18	131,5	3.54	90,0	0.39	10,0
2.30	58,5	8	1.08	27,4	1.52	38,6	1.84	46,7	1.94	49,4	0.47	12,0
2.97	75,5	10	1.40	35,5	1.74	44,1	2.49	63,3	2.26	57,5	0.47	12,0
3.63	92,3	12	1.74	44,1	1.92	48,7	3.16	80,3	2.60	66,1	0.47	12,0
4.65	118,0	15	2.20	55,9	2.19	55,5	4.13	109,0	3.07	77,9	0.47	12,0
5.63	143,0	18	2.70	68,6	2.40	61,0	4.20	120,0	2.95	91,0	0.47	12,0

Slider Support System for Straight Running Belts

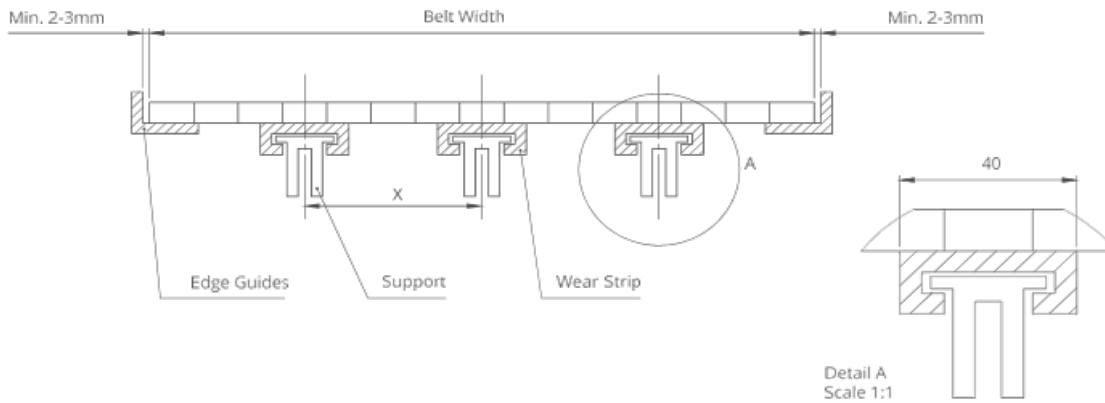

Note: The max. distances between the wear strips have to be (X) ;

125 mm for 2" belts
80 mm for 1" / 0.5" belts

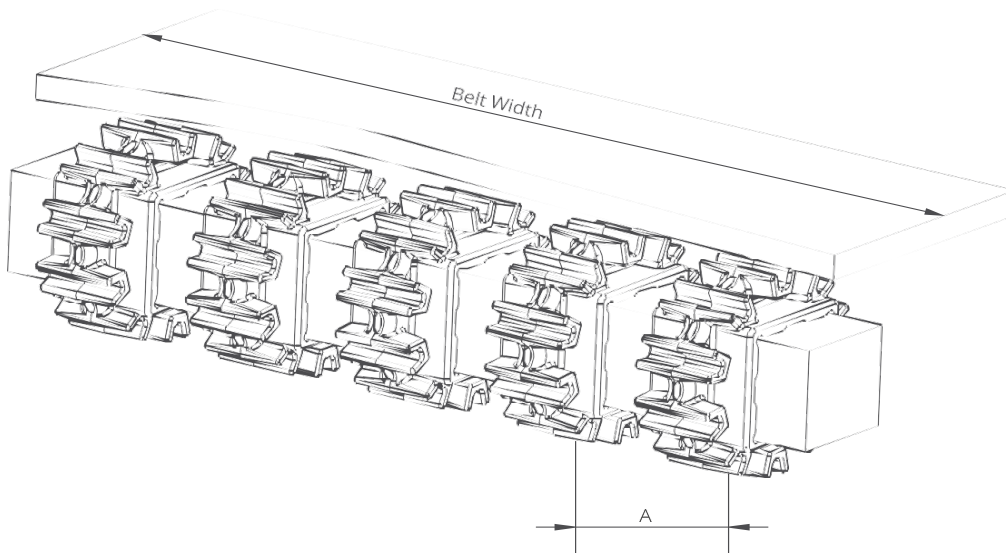

Sprockets Arrangement

Standard Belt Width		Number of sprockets per shaft		A (mm/inch)	
mm	inch	Drive Shaft	Return Shaft	Min.	Max.
152,4	6.0	2	2	60/2.36	170/6.6
228,6	9.0	2	2	60/2.36	170/6.6
304,8	12.0	3	2	60/2.36	170/6.6
381,0	15.0	4	3	60/2.36	170/6.6
457,2	18.0	5	3	60/2.36	170/6.6
533,4	21.0	5	3	60/2.36	170/6.6
609,6	24.0	6	3	60/2.36	170/6.6
685,8	27.0	6	4	60/2.36	170/6.6
762,0	30.0	7	4	60/2.36	170/6.6
838,2	33.0	7	4	60/2.36	170/6.6
914,4	36.0	8	4	60/2.36	170/6.6
990,6	39.0	8	5	60/2.36	170/6.6
1066,8	42.0	9	5	60/2.36	170/6.6
1143,0	45.0	9	5	60/2.36	170/6.6
1219,2	48.0	10	5	60/2.36	170/6.6
1295,4	51.0	10	6	60/2.36	170/6.6
1371,6	54.0	11	7	60/2.36	170/6.6
1447,8	57.0	11	7	60/2.36	170/6.6
1524,0	60.0	12	7	60/2.36	170/6.6
1600,2	63.0	12	8	60/2.36	170/6.6
1676,4	66.0	12	8	60/2.36	170/6.6
1752,6	69.0	13	8	60/2.36	170/6.6
1828,8	72.0	14	9	60/2.36	170/6.6
1905,0	75.0	14	9	60/2.36	170/6.6
1981,2	78.0	15	10	60/2.36	170/6.6
2057,4	81.0	15	10	60/2.36	170/6.6